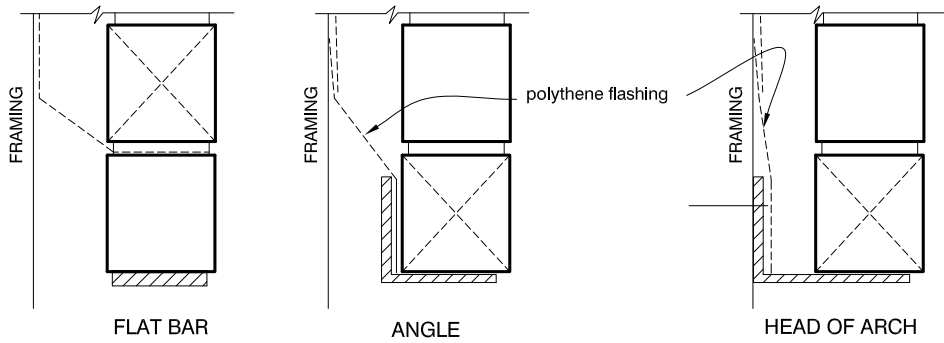

**FIG. 105 GALVANISED STEEL LINTELS**



100 x 75 x 6 angle may be bent to a radius of 500mm using a Comac Section Bending machine.  
 Fix angle using 75 x 10mm galv. coach screws at 450mm crs.  
 Stop steel at edge of opening.

1. For durability requirements refer to NZS3604 and NZBC, for lintel protection in seaspray, geothermal, and hot spot locations.
2. For openings greater than 2.0m provide a landing of 200mm each side of opening.
3. For openings less than 2.0m allow 100mm. Prop flat bars until bricks have set.
4. Provide brick ties within the bottom two courses.
5. Install polythene flashings and weepholes

**LINTEL SPAN TABLE (Engineered by BRANZ)**

Max. Span (mm)	70 SERIES Height of veneer above lintel			90 SERIES Height of veneer above lintel		
	350 (4 courses)	700 (8 courses)	2000 (unlimited)	350 high	700 high	2000
1500	60 x 10	60 x 10	60 x 10	80 x 10	80 x 10	80 x 10
2000	80 x 80 x 6	80 x 80 x 6	80 x 80 x 6	80 x 80 x 6	80 x 80 x 6	80 x 80 x 6
2500	80 x 80 x 6	80 x 80 x 6	80 x 80 x 6	80 x 80 x 6	80 x 80 x 6	80 x 80 x 8
3000	80x 80 x 6	80 x 80 x 6	125 x 75 x 6	80 x 80 x 6	80 x 80 x 8	90 x 90x 10
3500	80 x 80 x 6	80 x 80 x 6	125 x 75 x 6	80 x 80 x 8	90 x 90 x 10	125 x 75 x 10
4000	80 x 80 x 8	125 x 75 x 6	125 x 75 x 10	80 x 80 x 10	125 x 75 x 6	150 x 90 x 10
4500	125 x 75 x 6	125 x 75 x 6	125 x 75 x 10	125 x 75 x 6	125 x 75 x 10	150 x 90 x 12
4800	125 x 75 x 6	125 x 75 x 10	125 x 75 x 10	125 x 75 x 6	150 x 90 x 10	150 x 90 x 12

**STEEL WEIGHT**

60 X 10	- 4.8 kg/m	125 x 75 x 6	- 9.16 kg/m
80 x 80 x 6	- 7.5 kg/m	125 x 75 x 10	- 14.2 kg/m
100 x 75 x 6	- 8.0 kg/m	150 x 90 x 10	- 17.3 kg/m

**STAINLESS STEEL LINTELS**

Engineering Producer Statement from DME Consulting Ltd, covers the following table.

Max. Span in mm	70 Series Clay Bricks Height of brick veneer above lintel		
	350mm (4 courses)	700mm (8 courses)	2000mm (unlimited)
800	60 x 10	60 x 10	60 x 10
2000	65 x 65 x 6	65 x 65 x 6	65 x 65 x 6
2500	65 x 65 x 6	65 x 65 x 6	75 x 75 x 6
3000	65 x 65 x 6	75 x 75 x 6	
3500	75 x 75 x 6		

**NOTE:**

Due to the cost of stainless steel, 60 x 10mm flat may be used as indicated although it is recommended that angle be used in all situations as it allows the openings to be more easily flashed. Trade prices should be obtained from more than one source.